



**Technical Service
Information Bulletin**

March 23, 2001

Title:

**NEW SEAT BELT TONGUE PLATE
STOPPER SERVICE PARTS**

Models:

All Applicable Models

BO005-01

BODY

Introduction A new service part for seat belt tongue plate stoppers has been introduced. Installation procedures are provided to supplement the Repair Manual.

**Applicable
Vehicles**

MODEL	YEAR
LS 400	1990 – 2001
ES 250	1990 – 1991
ES 300	1992 – 2001
SC 400	1992 – 2001
SC 300	1992 – 2001
GS 400	1993 – 2001
GS 300	1993 – 2001
LX 450	1996 – 1998
LX 470	1998 – 2001
RX 300	2000 – 2001

**Parts
Information**

PREVIOUS PART NUMBER	CURRENT PART NUMBER	PART NAME
N/A	73219-02010	Stopper, Tongue Plate (Black)*
N/A	73219-02020	Stopper, Tongue Plate (Gray)*
N/A	73219-02030	Stopper, Tongue Plate (Beige)*

* Use a stopper color that is closest to the seat belt webbing color.

**Warranty
Information**

OP CODE	DESCRIPTION	TIME	OPN	T1	T2
BD0046	Install Seat Belt Tongue Plate Stopper	0.1	73219-020#0	62	12

Applicable Warranty*:

This repair is covered under the Lexus Comprehensive Warranty. This warranty is in effect for 48 months or 50,000 miles, whichever occurs first, from the vehicle's in-service date.

* Warranty application is limited to correction of a problem based upon a customer's specific complaint.



Lexus Supports ASE Certification

**Installation
Procedure****1. Preparation**

- A. Shift the Tongue Plate to the upper portion of the Tongue Plate Stopper, and temporarily hold it with a clip or tape.
- B. Remove any pieces of the original Tongue Plate Stopper in the webbing with a pair of pliers.

CAUTION:

Damaged or weakened seat belts may break in an accident and injure the occupant. The seat belt assembly must be replaced if:

- The webbing is cut, frayed, worn, or damaged.
- It has been used in a severe impact.

Inspect the entire length of webbing for damage and replace the assembly if needed. Be careful not to damage the webbing during repair.

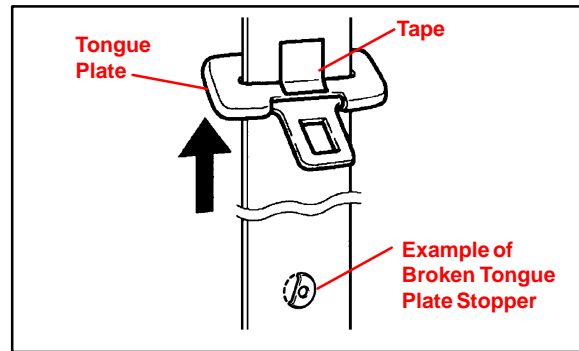
**2. Install the Tongue Plate Stopper**

- A. Install a new Tongue Plate Stopper in the hole of the webbing.

NOTE:

Be aware of the installation direction of the Tongue Plate Stopper as shown in the illustration.

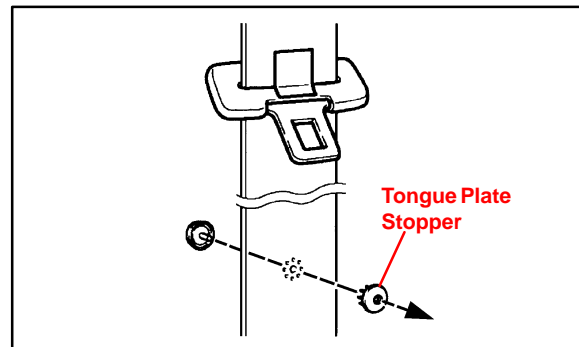

- B. Pinch the Tongue Plate Stopper into the webbing using an adjustable wrench, and turn and push the adjustment screw by hand.

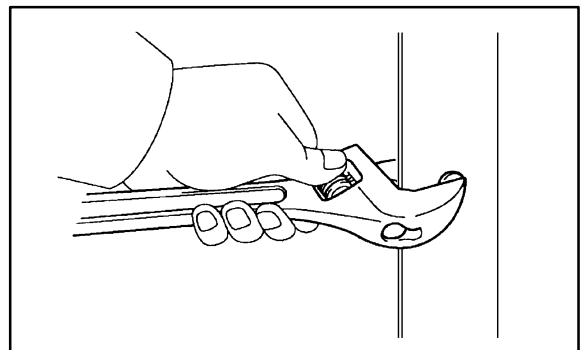
**HINT:**

Press the adjustment screw in order to position the male and female parts of the Tongue Plate Stopper parallel to each other, as shown in illustration.

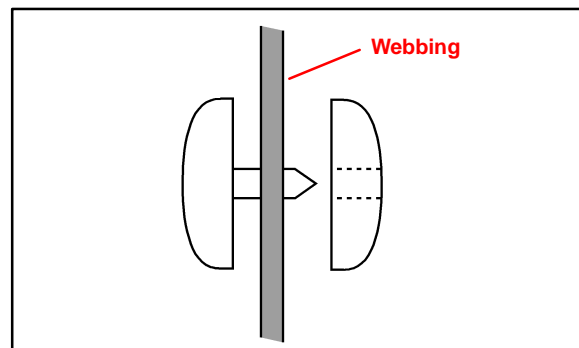
**CAUTION:**

DO NOT use pliers. They may damage the webbing.

**Installation
Procedure**
(Continued)

- C. When the adjustment screw for the adjustable wrench can't be turned by hand, tighten the adjustment screw using a pair of adjustable joint pliers until the space between jaws of the adjustable wrench is 4.5 – 5.0 mm. (See illustrations.)

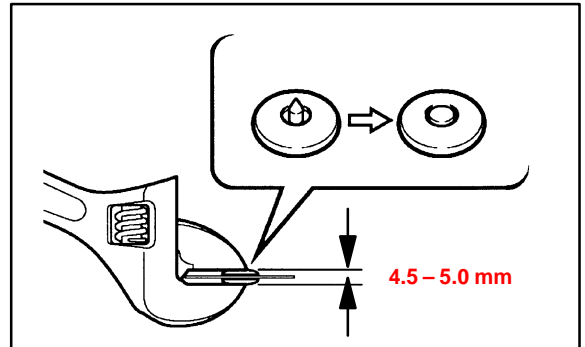
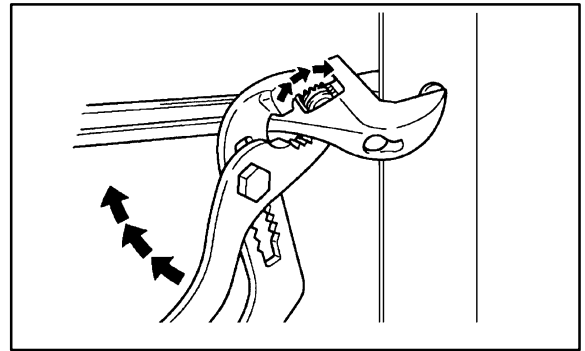

- D. Check to be sure that the male pin of the Tongue Plate Stopper has become deformed evenly in the hole of the female part and is firmly held to the belt webbing. (See illustrations.)

